



## Specifications 规格

**Class of Operation 保持特性 :** aR

**Standard 标准 :** UL248-13

**Rating 电气参数 :** Amps: 1A-50A  
Volts: 600V ac/dc

**Interrupting Capacity 分断能力:** 50kA @600Vac  
20kA @600Vdc

## Electrical Characteristics 电气特性

Part Number 物料				Rated current 电流	Pre-arc 弧前	I <sup>2</sup> t(A <sup>2</sup> Sec)		Safety Approvals 安全认证
1HEV600-xxA	1HEV600-xxAP	1HEV600-xxB	1HEV600-xxC			Clearing at 700V 熔断	Watts Loss at 1.0In 功耗	
1HEV600-1A	1HEV600-1AP	1HEV600-1B	1HEV600-1C	1A	-	-	-	●
1HEV600-2A	1HEV600-2AP	1HEV600-2B	1HEV600-2C	2A	-	-	-	●
1HEV600-3A	1HEV600-3AP	1HEV600-3B	1HEV600-3C	3A	-	-	-	●
1HEV600-4A	1HEV600-4AP	1HEV600-4B	1HEV600-4C	4A	-	-	-	●
1HEV600-5A	1HEV600-5AP	1HEV600-5B	1HEV600-5C	5A	1.6	11	1.5	●
1HEV600-6A	1HEV600-6AP	1HEV600-6B	1HEV600-6C	6A	-	-	-	●
1HEV600-10A	1HEV600-10AP	1HEV600-10B	1HEV600-10C	10A	3.6	22	4	●
1HEV600-15A	1HEV600-15AP	1HEV600-15B	1HEV600-15C	15A	10	75	5.5	●
1HEV600-20A	1HEV600-20AP	1HEV600-20B	1HEV600-20C	20A	26	180	6	●
1HEV600-25A	1HEV600-25AP	1HEV600-25B	1HEV600-25C	25A	44	320	7	●
1HEV600-30A	1HEV600-30AP	1HEV600-30B	1HEV600-30C	30A	58	450	9	●
1HEV600-32A	1HEV600-32AP	1HEV600-32B	1HEV600-32C	32A	68	600	7.6	●
1HEV600-40A	1HEV600-40AP	1HEV600-40B	1HEV600-40C	40A	84	750	8	●
1HEV600-50A	1HEV600-50AP	1HEV600-50B	1HEV600-50C	50A	200	1800	9	●

## Dimensions 尺寸 (Unit: mm)

1HEV600-xxA

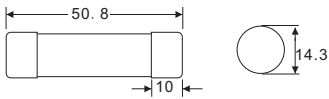

1HEV600-xxAP

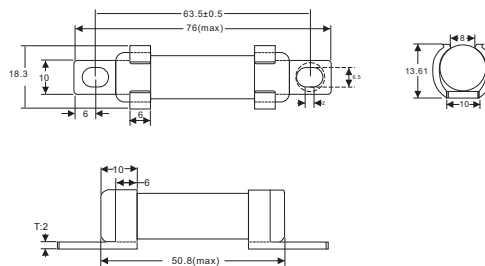

1HEV600-xxB

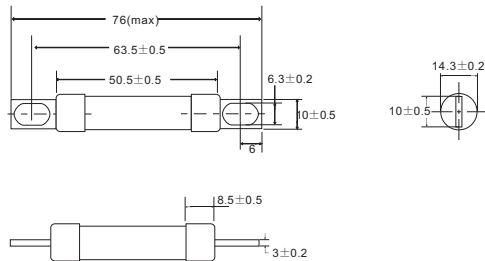

1HEV600-xxC

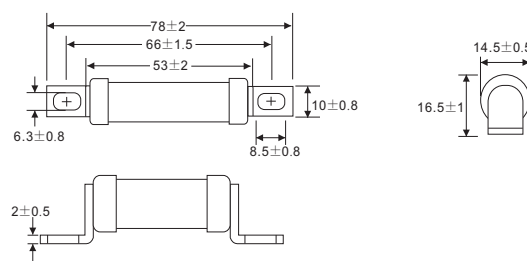

## Time-Current Curve 时间-电流曲线

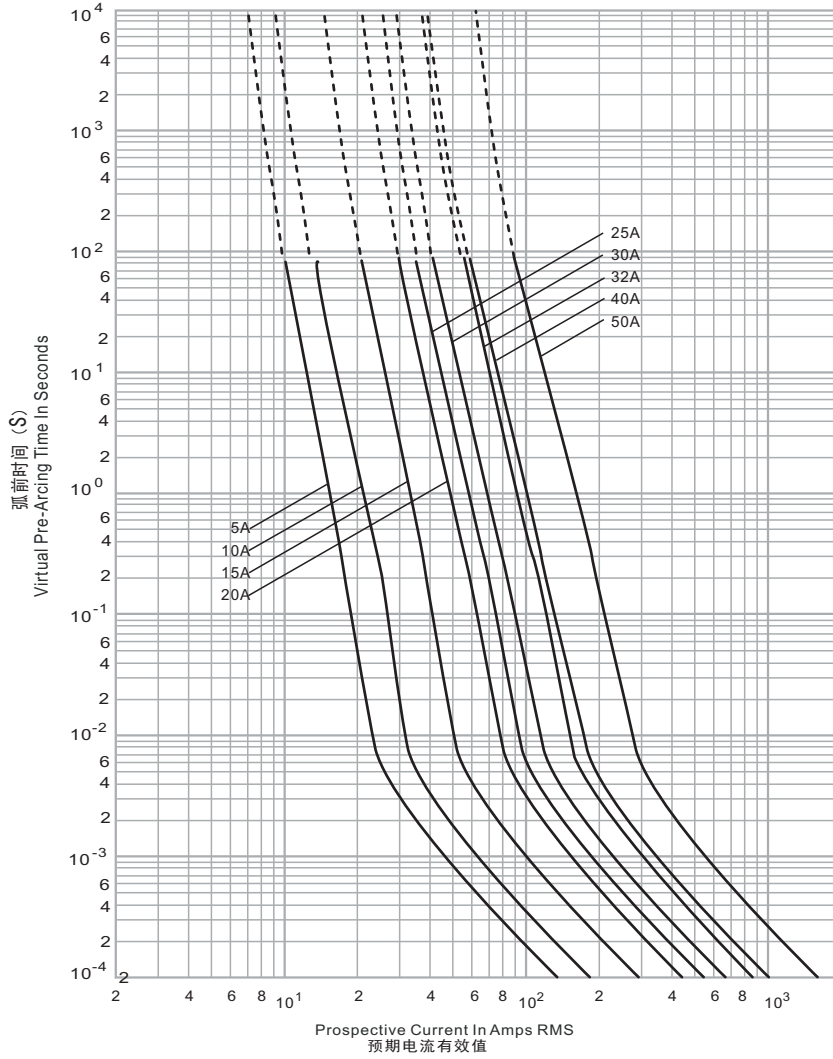

## Peak Let-Through Curve 截断电流特性

